

Front Hub HB-RM65 For Disc Brake

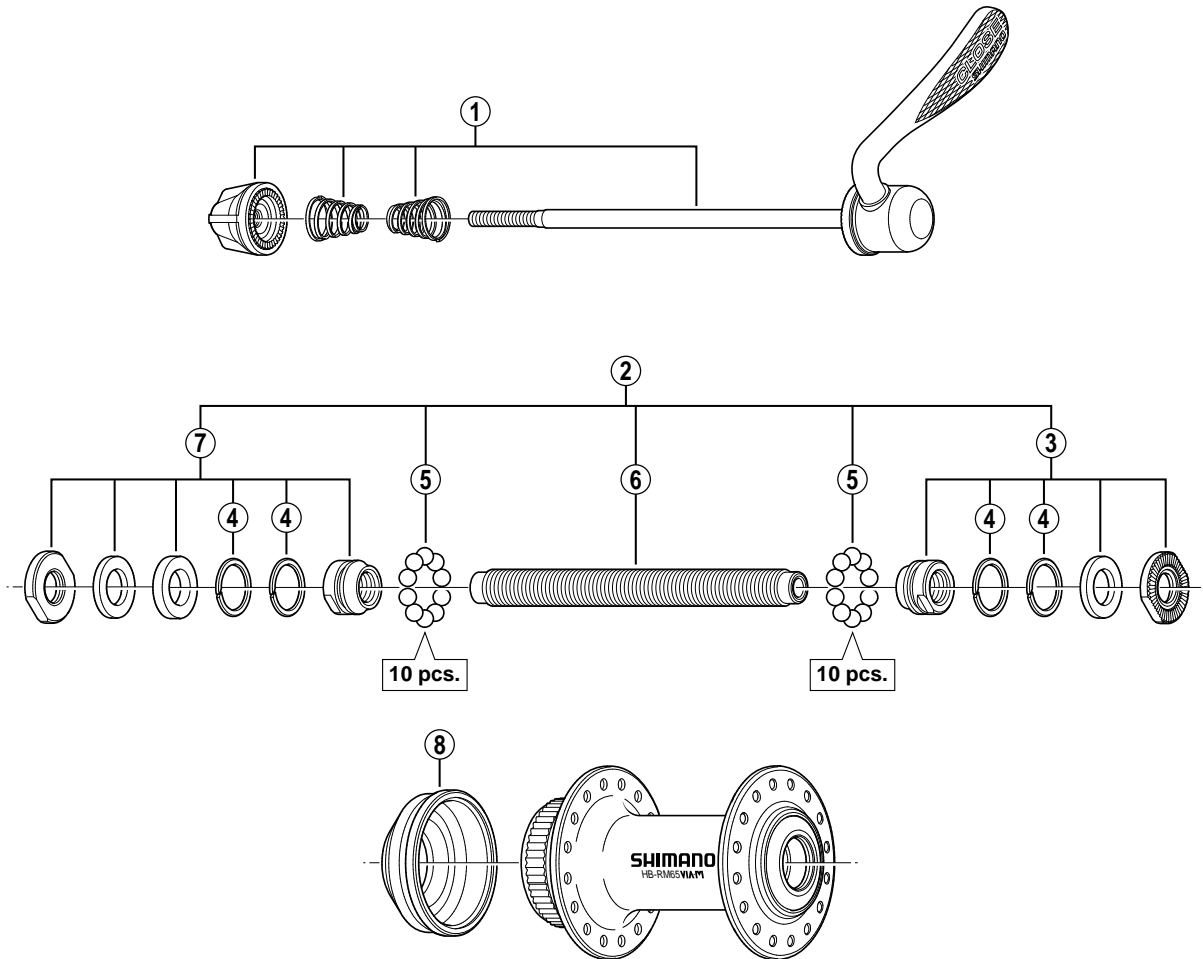

• Over Lock Nut Dimension: 100 mm (3-15/16")

ITEM NO.	SHIMANO CODE NO.	DESCRIPTION	INTERCHANGEABILITY		
1	Y-2T3 98010	Complete Quick Release 133 mm (5-1/4")	A	A	A
2	Y-2TC 98010	Complete Hub Axle 108 mm (4-1/4")			A
3	Y-2TC 98020	Right Hand Lock Nut Unit			A
4	Y-236 03000	Seal Ring			A
5	Y-000 91210	Steel Ball (3/16") 20 pcs.	A	A	A
6	Y-25W03000	Hub Axle 108 mm (4-1/4")			A
7	Y-2TC 98030	Left Hand Lock Nut Unit			A
8	Y-24Z 02000	Rotor Mount Cover (Option)			A

HB-RM60
HB-M495A
HB-M495

A: Same parts.

B: Parts are usable, but differ in materials, appearance, finish, size, etc.

Absence of mark indicates non-interchangeability.

0806-2534A

Specifications are subject to change without notice.

SHIMANO